

Thank you for purchasing a Trimalco product. Manufactured in the UK to a high standard this product will, if used according to these instructions and properly maintained, give you years of trouble free performance



**IMPORTANT:** PLEASE READ THESE INSTRUCTIONS CAREFULLY. NOTE THE SAFE OPERATIONAL REQUIREMENTS, WARNINGS & CAUTIONS. USE THE PRODUCT CORRECTLY AND WITH CARE FOR THE PURPOSE FOR WHICH IT WAS INTENDED. FAILURE TO DO SO MAY CAUSE DAMAGE OR PERSONAL INJURY, AND WILL INVALIDATE THE WARRANTY.

PLEASE KEEP INSTRUCTIONS SAFE FOR FUTURE USE.

### 1. CONTENTS

After unpacking the EUROPA Table, check to make sure that you have all the parts and that there is no damage.

#### 1.1 EUROPA Table components:

Model 4091 EUROPA 100 Table	2 x Box A	1 x Box C		
Model 4092 EUROPA 150 Table	2 x Box A	1 x Box E		
Model 4093 EUROPA 200 Table	2 x Box A	1 x Box B	2 x Box C	
Model 4094 EUROPA 250 Table	2 x Box A	1 x Box B	2 x Box D	
Model 4095 EUROPA 300 Table	2 x Box A	1 x Box B	2 x Box E	
Model 4096 EUROPA 350 Table	2 x Box A	2 x Box B	1 x Box C	2 x Box D
Model 4097 EUROPA 400 Table	2 x Box A	2 x Box B	1 x Box C	2 x Box E
Model 4098 EUROPA 450 Table	2 x Box A	2 x Box B	3 x Box E	
Model 4099 EUROPA 500 Table	2 x Box A	3 x Box B	4 x Box D	

Contents Box A (End frame)	Contents Box B (Centre frame)	Contents Box C	Contents Box D	Contents Box E
2 x Beam L=830	2 x Beam L=830	4 x Beam L=1000	4 x Beam L=1250	4 x Beam L=1500
2 x Leg L=870	2 x Leg L=870			
8 x Joining brackets	12 x Joining brackets			
3 x Worktop brackets	2 x Worktop brackets			
1 x Spacer	1 x Spacer			
1 x 4mm Allen key				

### 2. ASSEMBLY - BOX A (End frame)

- 2.1 Using the spacer, fit the first bracket to the top of the leg as shown in 1.. Ensure that the spacer is slightly above the level of the leg and ensure that the grub screw is tightened fully. When fitting the second bracket to the top of the leg ensure that it is fitted the correct way round (the flat edge always goes to the inside) as in figure 2.
- 2.2 Fit the brackets to the bottom of the legs using a tape measure or spacer to position them to suit your requirements. Ensure that the brackets are fitted the correct way round and that the grub screws are tightened fully.
- 2.3 Repeat 2.1 and 2.2 for the second leg.
- 2.4 Lay one of the leg assemblies on the floor and insert the beam sections as shown in figure 4. Place the second leg assembly on top to complete the end frame. Once everything is positioned properly with no gaps between the leg and beam extrusion, tighten the grub screws.

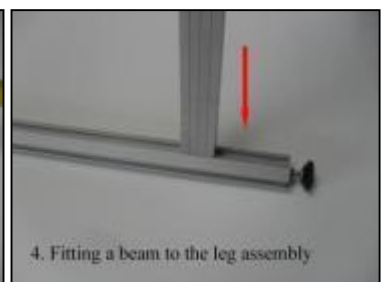
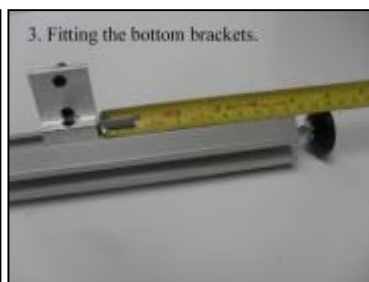
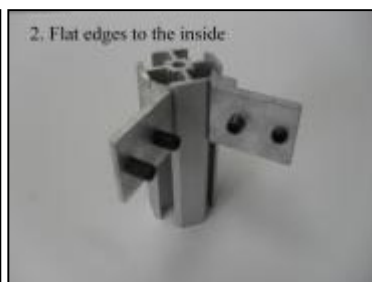
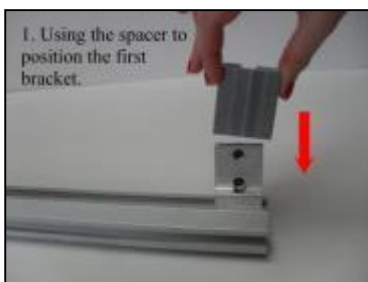

### 3. ASSEMBLY - BOX B (Centre frame)

- 3.1 Follow the instructions for ASSEMBLY - BOX A (End frame).
- 3.2 Add a third bracket to the top and bottom of both legs as shown in figure 5.

### 4. ASSEMBLY - BOXES C,D and E

- 4.1 Place one End frame on the floor with the brackets pointing up and position a beam over each bracket.
- 4.2 Place the other End frame (1.0m and 1.5m) or Centre frame (2.0m and longer) over the beams and tighten the grub screws ensuring that there are no gaps.
- 4.3 For tables 2.0m and longer, stand the frame on its feet and add beams and End/Centre frames as required. Tighten the grub screws ensuring there are no gaps.





INSTRUCTIONS FOR:

# EUROPA Table (Page 2 of 2)

Models: 4091,92,93,94,95,96,97,98,99

Thank you for purchasing a Trimalco product. Manufactured in the UK to a high standard this product will, if used according to these instructions and properly maintained, give you years of trouble free performance



**IMPORTANT:** PLEASE READ THESE INSTRUCTIONS CAREFULLY. NOTE THE SAFE OPERATIONAL REQUIREMENTS, WARNINGS & CAUTIONS. USE THE PRODUCT CORRECTLY AND WITH CARE FOR THE PURPOSE FOR WHICH IT WAS INTENDED. FAILURE TO DO SO MAY CAUSE DAMAGE OR PERSONAL INJURY, AND WILL INVALIDATE THE WARRANTY.

PLEASE KEEP INSTRUCTIONS SAFE FOR FUTURE USE.

**5. LEVEL THE TABLE**

- 5.1 On the EUROPA 100 Table and 150 Table adjust each foot so that every leg is firmly in contact with the floor. There is no need to use a level for this operation, it is enough to ensure that all legs are firmly in contact with the floor and that the table does not rock from side to side
- 5.2 On the EUROPA 200 Table and above, a long level will be required to ensure that the centre frames are at the correct height.

**6. WORKTOP FIXING**

- 6.1 The worktop is not supplied, we recommend 18mm MDF or similar cut to the following sizes.
 

EUROPA 100 Table	One 1370 x 950mm	EUROPA 150 Table	One 1870 x 950mm
EUROPA 200 Table	Two 1185 x 950mm	EUROPA 250 Table	Two 1435 x 950mm
EUROPA 300 Table	Two 1685 x 950mm	EUROPA 350 Table	Two 1415 x 950mm & one 1040 x 950mm
EUROPA 400 Table	Two 1665 x 950mm & one 1040 x 950mm	EUROPA 450 Table	Two 1665 x 950mm & one 1540 x 950mm
EUROPA 500 Table	Two 1395 x 950mm & two 1290 x 950mm		
- 6.2 Fix the worktop in place using the brackets provided, position a bracket along the centre of each beam section and fix as shown in figure 6.

**7. GENERAL MAINTENANCE**

- 7.1 Regularly clean the EUROPA Table mount using a dry cloth, stubborn stains can be removed with a cloth dampened with a little water/detergent.

7.2

**8. SPARE PARTS**

- 8.1 Spare parts can be obtained by visiting our website at [www.trimalco.com](http://www.trimalco.com)

